

8 INCH 12 INCH SHOLLOW BASE

8 INCH SHOLLOW BASE

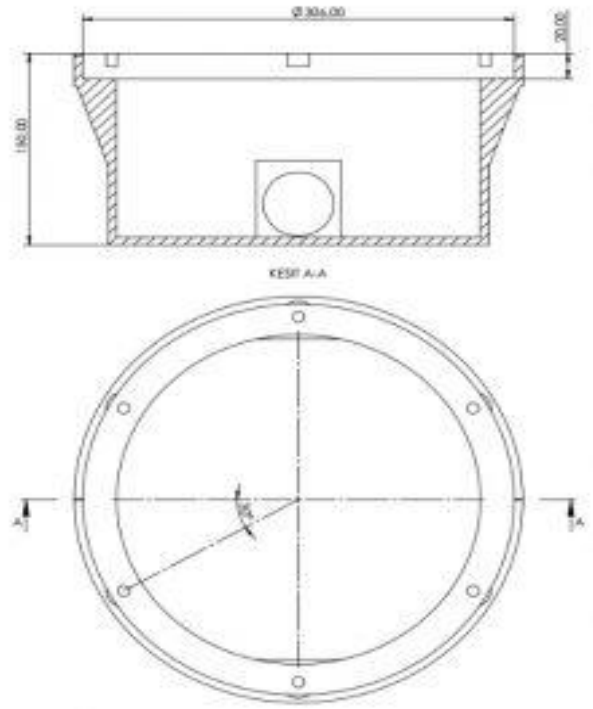

12 INCH SHOLLOW BASE

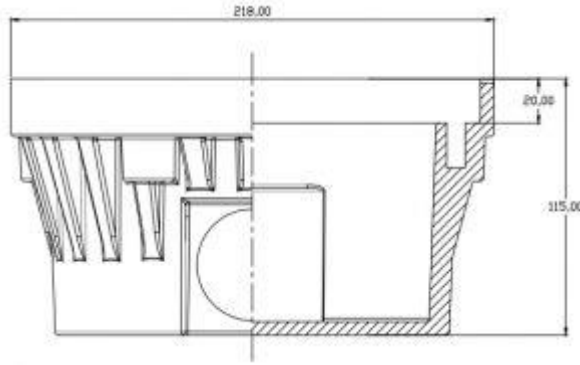

TEK.255.M.01.01
8 INCH SHOLLOW BASE

TEK.255.M.01.02
12 INCH SHOLLOW BASE



COMPLIANCES

ICAO annex 14 volume 1 (current edition)

FAA AC 150/5345-42

APPLICATIONS

There are two main methods for inset lights installation:

Shallow Bases: the isolating transformer and the primary circuit connectors are typically placed in a pit on the edge of the runway/taxiway and the light is powered by means of secondary cable reaching the base.

Deep Bases: the isolating transformer and the primary circuit connectors are typically placed within the same base housing the inset light. Therefore, these bases are used as underground junction boxes.

- The shallow base consists of a treated aluminium casting with a hole in the bottom suitable for conduit connection. As an alternative, shallow bases are equipped with one or two cable leads with receptacle inside the base through one or two cable glands.
- The base is equipped with an internal grounding screw with yellow-green cable lead, size 2.5 mm², 0.250 m long, with female fasten terminal for quick connection to the corresponding of the fixture. An additional external grounding screw is provided close to the cable entry.
- The shallow base is designed for cementing in place by means of epoxy-resin in a hole drilled in the pavement. A gasket (separately supplied) must be placed between base and fixture for water tightness placed in the relevant shallow base groove (only for 12" dia.).
- Hardware for fixing, screw and washer, are in stainless steel. On request, customized version is available.